

Fourth Edition under Revision

EXHIBITION
OF
ITALIAN ART 1200-1900

Patrons

THEIR MAJESTIES THE KING AND QUEEN

THEIR MAJESTIES THE KING AND QUEEN OF ITALY

1930

ROYAL ACADEMY OF ARTS

Burlington House, Piccadilly

LONDON, W.

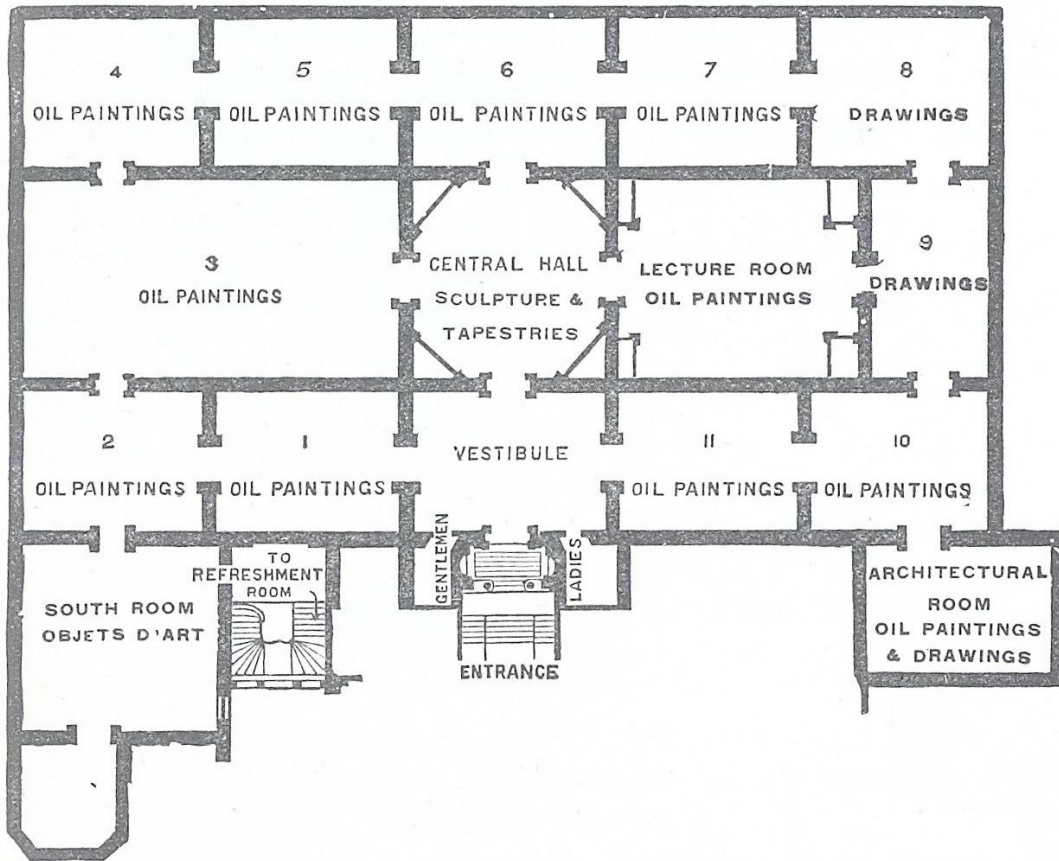

PLAN OF THE GALLERIES

- | | | |
|--|---|---|
| I. 14th and 15th Century—all Schools. | VI. 16th Century Venetian. | XI. 17th and 18th Century—all Schools. |
| II. 15th Century—all Schools. | VII. 16th Century—all Schools. | Architectural Room—18th Century—Venetian. |
| III. Late 15th and 16th Century—all Schools. | VIII. Drawings, Florentine and Umbrian. | Lecture Room—Modern Painters. |
| IV. Late 15th and 16th Century—all Schools. | IX. Drawings, Venetian and Other Schools. | South Room—Objets d'Art and Paintings. |
| V. 15th Century Venetian and North Italian. | X. 17th Century—all Schools. | Central Hall—Sculpture and Tapestries. |

GEMITO (VINCENZO)

1852—Naples—1928.

898 Portrait of Giuseppe Verdi, Bronze

Lent by the MUSEUM OF THE SCALA THEATRE, MILAN.

ROSSO (MEDARDO)

1858 Turin—Milan 1928.

899 "Ecce Puer," Bronze

Lent by SIGNORA CORINNA UBERTI, MILAN.

BARTOLINI (LORENZO)

1777 Savigliano Pravese—Florence 1850.

900 Portrait of Teresa Guiccioli, Marble

Lent by COUNT CARLO GAMBA, FLORENCE.

CANOVA (ANTONIO)

1757 Possagno—Venice—Rome—Venice 1822.

901 Cupid and Psyche

Lent by the VILLA CARLOTTA, CADENABBIA (COMO).

Psyche, lying on her back, raises her arms to the head of Cupid, who bends down to kiss her, encircling her with his left arm.

Marble. Height: 50 in. (127 cm.).

Copy executed in 1827 by the Bolognese sculptor Adamo Tadolini, for Count Sommariva, and always preserved in the Villa Carlotta, Lake Como.

Lit.: V. Malamani, *Canova*, 55.

The copy only is shown, because the present whereabouts of the original is not known.